

Skyrockets

By Ronald Peterson, Viking Sewing Gallery 290
Bellevue, WA

Look at these skyrockets, all ready to go up and blow into a million pieces. What a blast!

This project is designed primarily to use several different techniques and feet. Yes, you could construct this picture much quicker, but the point is to get you out of your comfort zone. This project will explore:

- Doing embroidery appliqué
- Using the Chenille foot a little differently
- Sewing on buttons
- Using the Fab-U-Motion Fabric Mover with Stitch Regulator by Quilter's Cruise Control
- Playing with decorative stitches
- Using the Mini Beading foot

Sewing Supplies:

- 14" x 18" square of batting or Warm and Natural.
- 9" x 5" square of red, white, and blue cotton fabric
- 12" x 12" square of black cotton.
- 12" x 12" square of night sky colored fabric. I used "Stargazers" by www.RobertKaufman.com found at JoAnn's. If you don't like the sky so busy, use a square of navy blue.
- 12" length of silver twine
- 10 star-shaped buttons—I used the ones from "Favorite Findings".
- 12" length of 3/8" grosgrain ribbon, one in red, one in white, one in blue
- Thread:
 1. R/A 2604—Light Maize
 2. R/A 644-2280—Sapphire
 3. R/A 644-2378—Red
 4. R/A Metallic 644GOVTGOLD—Govt Gold
 5. R/A Metallic 644EMERALD—Emerald
 6. R/A Metallic 644RED—Red
 7. R/A 2296—Black
 8. R/A 2297—Snow White
- Chenille Foot #412 97 52-45
- Black or Navy Fabrico pens



- Fray Check
- Mini Beading foot #412 70 11-45
- Braiding foot guide #412 55 44-45
- Embroidery scissors
- Tailor's Chalk or Chakoliner
- NEBS pre-wound bobbins
- Scotch tape
- Fab-U-Motion Fabric Mover with Stitch Regulator by Quilter's Cruise Control attached to an appropriate Husqvarna Viking Sewing/Embroidery machine
- Black Tear-A-Way stabilizer
- White Tear-A-Way stabilizer

- OPTIONAL: Googly eyes, medium sized.
- OPTIONAL: Glue Sticks

Skyline background:



1. Cut out the buildings as shown above, but remember: the more sky, the bigger fireworks you can do.
2. Place the buildings on the night sky fabric as shown.
3. Place the building and night sky fabric on the piece of batting as shown.
4. Pin all the layers in place to keep the building from shifting. ALTERNATE: Use the Elmer's glue sticks to keep the building fabric in place. It dries clear, doesn't stain and washes out.
5. Carefully straight stitch around the buildings using R/A 2296 "Black" in both the bobbin and the needle in the sewing machine. Don't worry about the raw edges - we'll take care of them during the free motioning.

Fireworks:



1. Pin the top of the sky and then draw chalk lines where you want the fireworks. Have the fireworks fill the sky, and try to get a couple of them to overlap.

NOTE: If you're one of the non-drawing types, just copy the drawing here of a firework explosion.

Select D1:11 . Thread with metallic red, and start in the middle of any firework explosion.

2. You'll notice that this stitch has 3 dashes, and then the star. If you are doing the dashes part of the stitch, try very hard to follow the line.

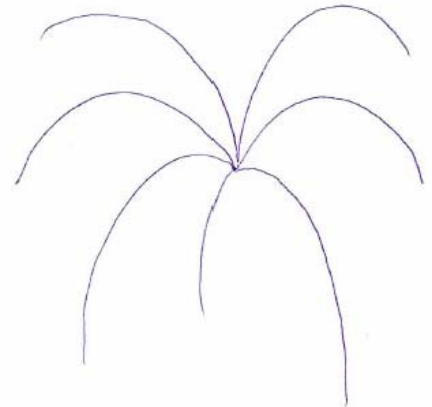

NOTE: I frequently make one stitch, then pivot the project a little so that I follow the curves as close as I can. If you're really uncertain, practice first on scrap fabric using just a straight stitch.

3. Repeat for blue (or green - your choice) and again for gold.
4. This is what your fireworks should look like when you get done.
5. Extra Credit: Try programming other stitch combinations together for different effects. Don't forget 3 dashes between each stitch.

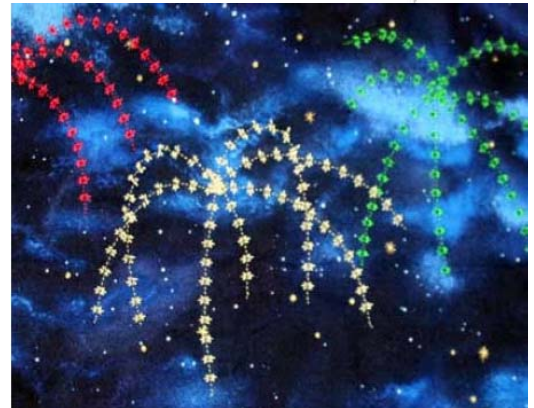

Fab-U-Motion Fun:

1. Now let's tack down the buildings. Attach your Fab-U-Motion Fabric Mover with Stitch Regulator by Quilter's Cruise Control, and go a little wild drawing black (R/A 2296) straight lines up and down until all the black has lines on it.

Don't do it all in up and down—Some buildings should have horizontal lines, and a couple can be an angular spiral. Here's a picture of what I'm looking for.

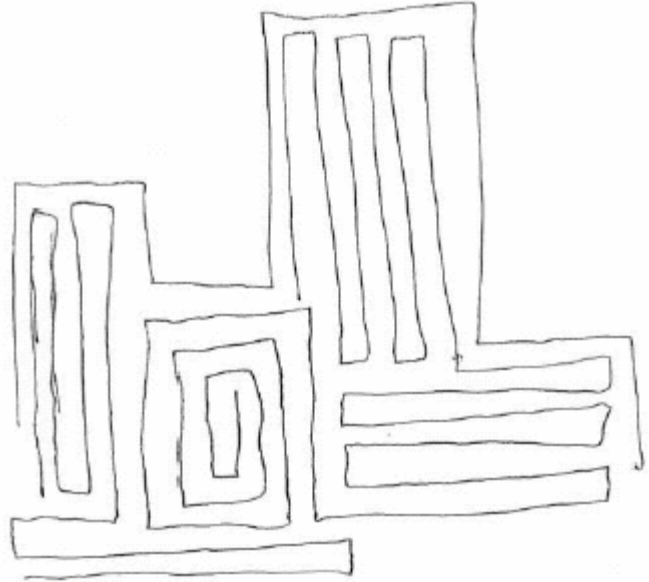

2. Now run around all the edges of the buildings to tack down all those nasty raw edges. ALTERNATE: Satin stitch the edges down for a different look.

Skyrocket Ribbon:

1. Let's do the hardest one first. Go to your sewing machine, load it with R/A 2296 Black, and

select D1:11  that we used for the fireworks.

2. Attach the Chenille foot, and notice that the Chenille foot can accommodate very large ribbon. The 3/8" grosgrain ribbon is too wide for the fancy trim foot, so we're going to use tape to channel the ribbon in the middle of the foot.

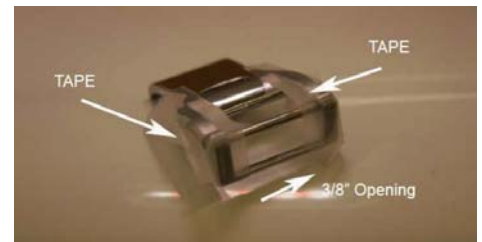

If you flip the foot over, you'll see that I have taped both sides of the foot, leaving a 3/8" opening for the ribbon.

3. Once you have the foot on and your stitch selected, place a 10" x 8" square of tear-away stabilizer under the foot. Insert a 6" length of grosgrain ribbon all the way through the Chenille foot. Stitch in a straight line on the tear-away stabilizer.
4. Now stitch another color right next to the first one. By lining up the ribbon with the edge of the tape, your ribbon will line up perfectly.



5. Continue until you've stitched twelve lines (4 lines of 3 colors each). You should have a bunch of ribbon that looks like this. We have created "ribbon fabric".

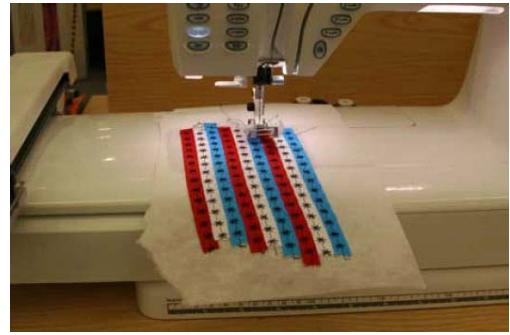

Skyrocket Embroidery:

1. The Free Monthly design for June, 2008 includes 3 different skyrockets which all stitch out at 200 mm high. If you can't embroider them out because you don't have a large enough hoop, you'll still be able to finish this project.
2. Now, if you have an embroidery machine that can stitch out 200mm tall, load the embroidery named "Final - skyrocket ribbon.vp3". Hoop tear-away stabilizer (no fabric), and then stitch out the first section. Place the ribbon "fabric" over the body of the skyrocket, then start the embroidery all over again. Using your embroidery scissors, trim away the excess ribbon outside of the stitching.

NOTE: If you can't embroider this large, just cut out a skyrocket body about 4.5" tall. Cut out a skyrocket top about 3.25" high. Satin stitch then together, and put googly-eyes on it.

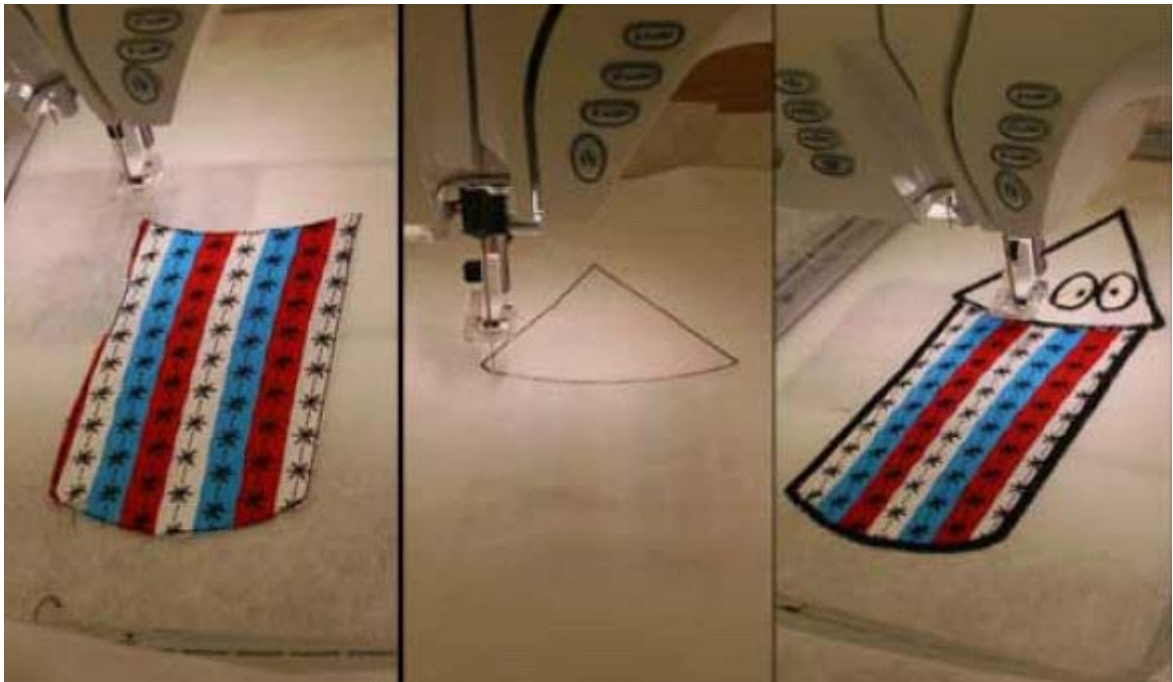

3. Place white cotton fabric over the embroidery surface. Press START to continue the embroidery.
4. When it stops, trim around the top, then press START to continue.

5. Finish the embroidery using the colors it asks for, and tear off the ribbon skyrocket appliqué
6. Remove the embroidery from the hoop, tear off the stabilizer, and use the black or dark navy Fabrico pens to make all the fibers on the edges black. If you use black tear away stabilizer, you'll just have to trim the tear-away off and not color it.

Skyrocket Button:

1. Hoop blue fabric and black tear-away stabilizer.
2. Stitch up to the stop command.
3. Trim closely around the edges.
4. Press Start.
5. Finish the embroidery using the colors it asks for, and tear off the ribbon skyrocket appliqué.
6. Remove the embroidery from the hoop, tear off the stabilizer, and trim the black tear-away stabilizer.

Skyrocket USA:

1. Hoop Red Fabric (I got fancy and used some that had glitter in it) and black tear-away stabilizer.
2. Stitch up to the Stop command.
3. Trim closely around the edges using your embroidery scissors.
4. Press START to start the embroidery up again.
5. Finish the embroidery using the colors it asks for, and tear off the USA skyrocket appliqué. Don't forget, I used GOVTGOLD for the USA word.
6. Trim any excess stabilizer.

Finishing up:

The end is in sight!! Just a few more steps remain to complete this masterpiece!

1. Place your skyrockets, and pin them. Be sure to leave 1.5" around the edges or you may cut off some of the picture when you bind this.
2. Straight stitch all around each skyrocket with Black EXCEPT for a small area at the bottom of each skyrocket—that's where you'll insert their fuses!



3. Do you remember how careful we had to be when we stitched the fireworks? We need to be careful again for the fuses.
4. Put scotch tape around the ends of the fuse cording before cutting off a 6-8" length. Tuck one end into the skyrocket, and then use pins to secure the fuses the way you want the it to look.

5. Attach the Mini Bead foot, and set your sewing machine to a zigzag stitch, width 2.5. Use R/A 2297 White, and drop the mini bead foot over the place where the fuse comes out of the skyrocket. Do a couple of zigzag stitches. Pivot the fabric every two or three stitches to make sure that the fuse follows the path you want. It's a little slow but you'll be happy that you took the time. The mini bead foot works perfectly for specialty cording, especially thicker cording that doesn't work well in the braiding foot.



6. Leave the ends dangling, and when you move the tape, fray the edges a little to look like the end of a fuse.
7. Complete stitching down the skyrockets over the place where the fuses come out using Black again.
8. Thread your machine with R/A 2604 (Light Maize), and set your machine to a satin stitch as wide as it will go. Satin stitch little 3/8" "windows" randomly on each building, and after you are done, but before you trim the dangly threads, use a little Fray Check on each windows to keep it in place.
9. Stitch a red star button on the red fireworks, a green button on the green fireworks, and a yellow one on the gold fireworks.
10. Stitch random buttons (no more than 8 please!) on the button skyrocket.
11. Stitch you name in the corner and you are done!

Serving Suggestions

- This would make a great panel for the side of a bag
- Bind it, frame it and hang it up at home
- Just do the skyrockets and use them as appliqués
- Bind it and make a hanging flag for your front door
- This can also adorn the center panel of a quilt
- Recreate this scene on the back of a jacket.