

*Designer Topaz™*

“Dream” Cushion

DREAM

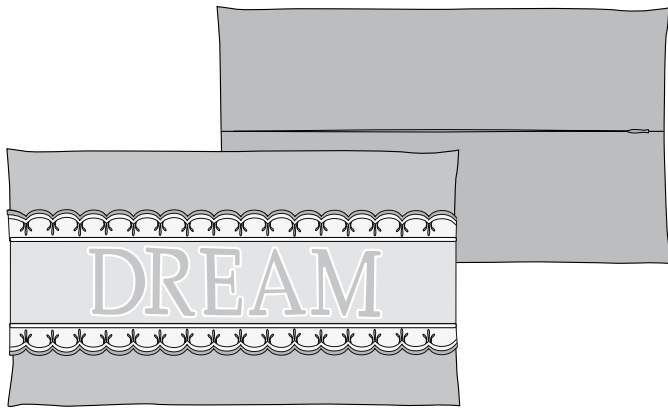

### *Sewing supplies*

- ❖ HUSQVARNA VIKING® DESIGNER TOPAZ™
- ❖ HUSQVARNA VIKING® Huskylock (optional)
- ❖ Dark red silk fabric 16" x 55" (40 cm x 140 cm)
- ❖ Light red silk fabric 14" x 21" (35 x 53 cm)
- ❖ Gold organza fabric 8" x 55" (20 x 140 cm)
- ❖ 48" (120) cm gold piping
- ❖ Invisible Zipper 16" ( 40 cm)
- ❖ Tear-Away stabilizer
- ❖ Interfacing
- ❖ Pins
- ❖ Rayon Embroidery thread in red and metallic gold colors.
- ❖ Embroidery bobbin thread
- ❖ Sewing Thread to match the fabric
- ❖ Pillow Form 20" x 12" (50 x 30 cm)

### *Husqvarna Viking® Accessories*

- Piping Foot (411 85 10-45) or Clear Piping Foot (413 09 71-45)
- Clear Seam Guide Foot 413 03 48-45
- Invisible Zipper Foot 412 68 70-45
- DESIGNER™ Royal Hoop (360 x 200 mm) or DESIGNER™ Crown Hoop (260 x 200 mm)
- Endless Embroidery Hoop (170 x 100 mm) 920 051-096
- 4D Quick Font software
- Embroidery collection #91-Endless Insertions & Thread Work, 412 88 29-01

You will find these and many other accessories in your HUSQVARNA VIKING® Accessory User's Guide, on web site [www.husqvarnaviking.com](http://www.husqvarnaviking.com), and for purchase at your nearest HUSQVARNA VIKING® Dealer.

### *Cut*

5/8" (1.5 cm) seam allowance included in all measurements.

#### **Dark red silk fabric**

- 2 pillow front pieces 5" x 21" (13 x 53 cm)
- 2 pillow back pieces 11"x 21" (28 x 53 cm)

#### **Light red silk fabric**

- 1 pillow front piece 13 ¾" x 21" (35 x 53 cm)

### *Embroider*

Make your own font in the 4D Quick Font Software: For instruction how to make a font in 4D Quick Font see the User's Guide for the quick font program. We have used font - Palatino Linotype, Style – Regular, stitch type - Fill + Satin border, size 80mm.

Save the font on USB stick. Set the machine for embroidery. Load the font to the machine. Program the text DREAM. Load the text to embroidery mode (for more info see your User's Guide).

Hoop the light red front piece with tear away stabilizer underneath in your DESIGNER® Royal Hoop (360 x 200 mm). For DESIGNER TOPAZ™ 20 create a smaller font that fits into the DESIGNER® Crown Hoop (260 x 200 mm).

Embroider the design: Use dark red embroidery thread for the fill areas and metallic gold for the satin borders.

Cut the piece to measure 5" x 21" (13 x 53 cm)

### *Sew*

Make your own embroidered edging by using the Husqvarna Viking Design CD #91-Endless Insertions & Thread Work, we used design #23. Hoop the organza fabric in the endless hoop with water soluble stabilizer underneath. Embroider following the instructions in the embroidery booklet until you have 43" (1,10 m) of edging.

Place the piping along long edges of the embroidered piece, place the embroidered edging on top, pin in place. Snap on the piping foot and sew the edging and piping in place.

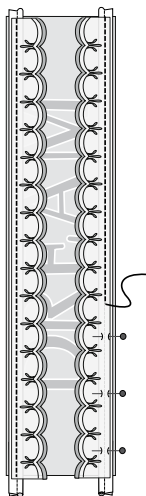

Place the dark red front pieces on top, pin and sew.

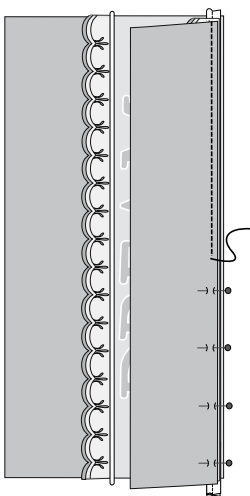

Press.

Snap on the Invisible Zipper Foot. Sew the invisible zipper between the long edges of the back pieces. For instructions how to sew an invisible zipper, see Accessory User's Guide.

Place the front piece on top of the back piece, right sides together, pin in place. Open the zipper enough to turn the cushion right side out. Snap on the Clear Seam Guide Foot, select Woven Medium, Seam on the Sewing Advisor and sew around all four sides. Overcast the seam allowances with your Huskylock or select Woven Medium, Overcast on the Sewing Advisor. Trim the corners and turn right side out through the zipper opening on the back.

Insert the pillow form.